

General arrangement

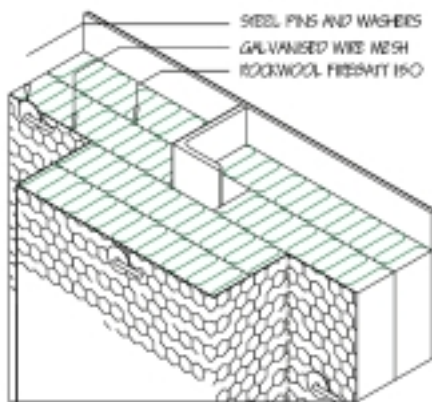

Insulation on stiffener side

- Location: Bulkhead or deck.
- Plate thickness: Minimum 4mm.
- Fire attack: Insulated side.
- Insulation: Rockwool Firebatt 150, 130mm (2x65mm).
- Wire mesh: Galvanised, grade No. 22.
- Steel pins: Carbon or stainless $\varnothing 3\text{mm}$.
- Steel washers: Carbon or stainless $\varnothing 35\text{mm}$

Sectional view

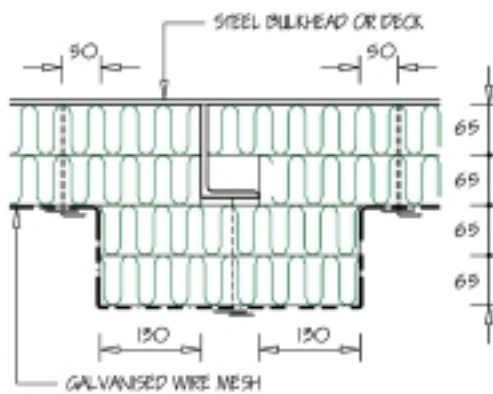

Applications:

- Steel bulkheads
- Steel decks

Application notes:

- Joints in Firebatt 150 to be tight-fitting butt joints.
- Joints between layers to be staggered.
- Wire mesh to overlap by 50mm and stitched at joints.
- Steel pins must be bent over the fixing washers.

Rockwool tip:

- Firebatt 150 can be supplied with factory applied aluminium foil.

Pinning arrangement

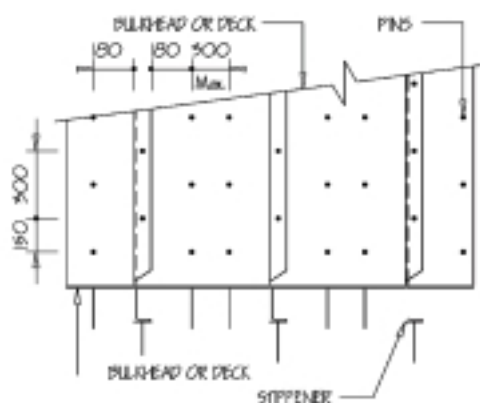

Note:

- The pinning arrangement shown is for welded pins only.

Recommendations:

- Use carbon steel pins on carbon steel structures and stainless steel pins on stainless structures.