

A-30 Steel Deck

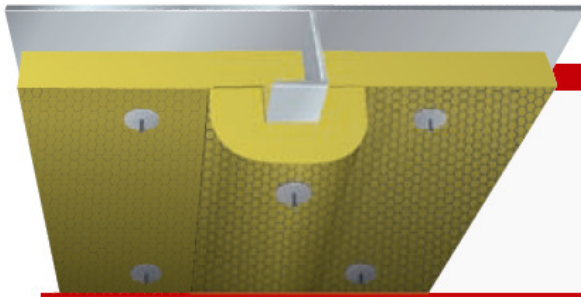

MED B-4186

Product: Rockwool Marine Wired Mat 90

Density: 90 kg/m³

Thickness: Plate 30 mm insulation
Stiffener 30 mm insulation

Construction:

- Plate between stiffeners insulated with one layer of 30 mm Rockwool Marine Wired Mat 90.
- Stiffeners insulated with min. 30 mm Rockwool Marine Wired Mat 90.
- Standard steel plate 4.5 mm (± 0.5 mm) thick.
- $\varnothing 3$ mm pins fixed with approx 300 mm distance.
- Insulation secured with washers of $\varnothing 38$ mm.

Application notes:

- All the connections must be tight, no air gaps.
- Gap under the stiffener must be filled out completely.
- The pins should exceed the insulation by approx 10 mm.
- Wire mesh must be twisted or clamped together at joints.

Advantages:



One layer solution



Fast installation

Surfaces:

- Reinforced aluminium foil
- Glass cloth

